

Endoscopy Instruments

Complete Catalogue of Accessories

FUJIFILM GROUP

FUJINON CORPORATION

1-324 UETAKE, KITA-KU, SAITAMA CITY, SAITAMA 331-9624, JAPAN
TEL : 81-48-668-2153 FAX : 81-48-668-1570
E-mail:sales@msv.fujinon.co.jp
URL <http://www.fujinon.co.jp/>

FUJINON INC.

10 HIGH POINT DRIVE, WAYNE, NJ 07470, U.S.A.
TEL : 1-800-490-0661 FAX : 1-973-633-8818
E-mail : med.info@fujinon.com
URL <http://www.fujinonendoscopy.com/>

FUJINON (EUROPE) GmbH

HALSKESTRASSE 4, 47877 WILLICH, GERMANY
TEL : 49-2154-924-0 FAX : 49-2154-924-290
E-mail : Fujinon@fujinon.de
URL <http://www.fujinon.de/>

FUJINON SINGAPORE PTE. LTD.

BLK 211 HENDERSON ROAD, #10-04 HENDERSON INDUSTRIAL PARK, SINGAPORE, 159552
TEL : 65-6276-4988 FAX : 65-6276-6911
E-mail : fujinon@fujinon.com.sg URL <http://www.fujinon.com.sg/>

FUJINON AUSTRALIA PTY. LTD.

UNIT-18, 52 HOLKER STREET, SILVERWATER N.S.W. 2128, AUSTRALIA
TEL : 61-2-9748-2744 FAX : 61-2-9748-2428
E-mail : sales@fujinon.com.au

SHANGHAI FUJINON MEDICAL EQUIPMENT CO., LTD.

FLAT B, 6/FL, SHI MEI BLD, 79 RI JING ROAD,
WAI GAO QIAO FREE TRADE ZONE, SHANGHAI, ZIP CODE: 200131 CHINA
TEL : 86-21-5424-9262(Office) TEL:86-21-5866-2151(Service)
FAX : 86-21-5866-2150 E-mail : fjng2001@hotmail.com

 To ensure safe operation, follow the instructions in the manual when handling the instruments.

*The appearance and specifications of the products in this catalog may be subject to change without notice.

SGE-053-00

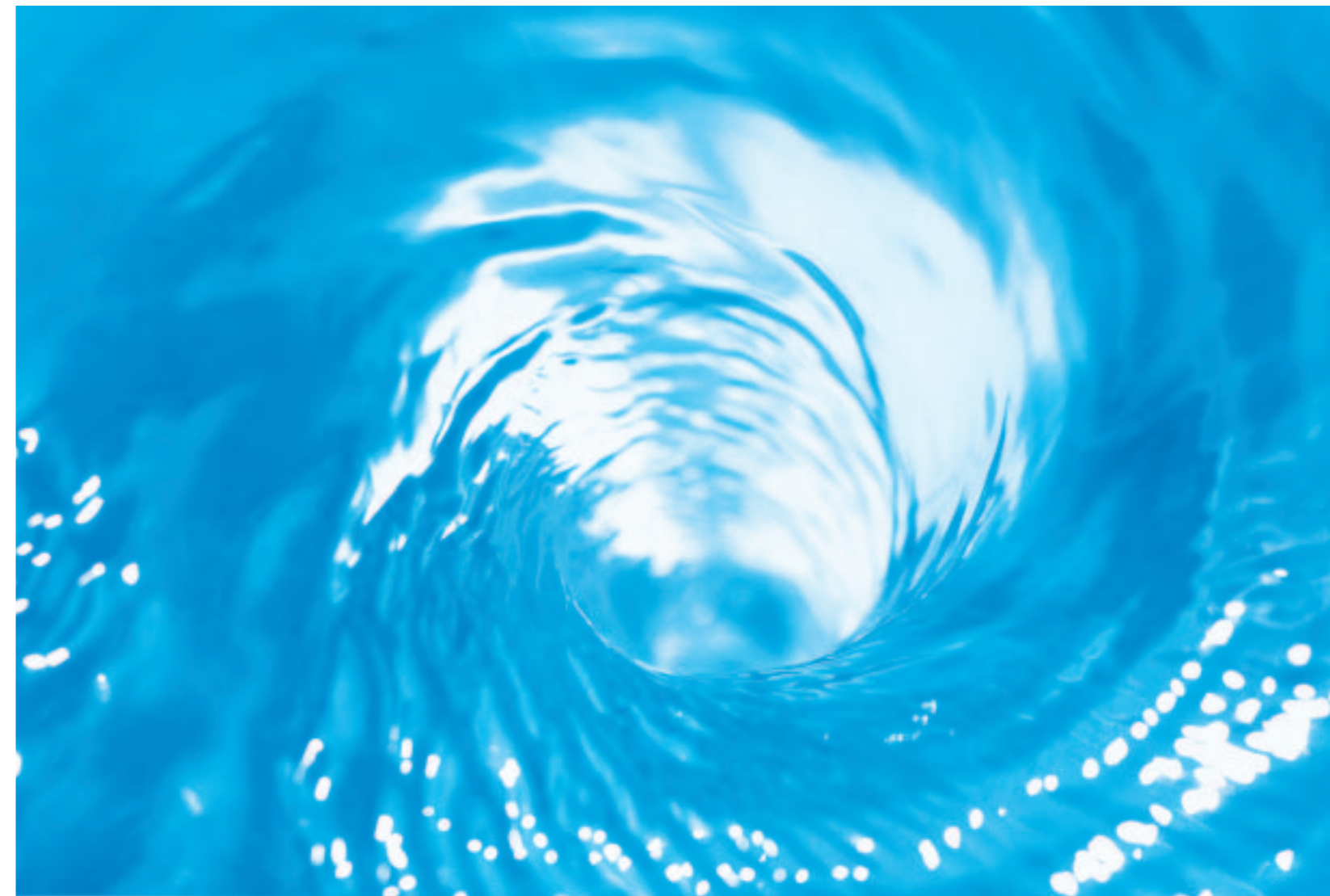

FUJINON
 **FUJIFILM**

Reliable, accurate and designed for quality— FUJINON's FT Series Endoscopic Instruments

Today's endoscopy instruments are facing ever more stringent requirements for accuracy and reliability, safety and outstanding maneuverability.

FUJINON has worked to improve the function, specifications and variety of its instruments to meet the needs of physicians. Biopsy forceps, injectors and other instruments have had their cutting edges refined to ensure procedures that are both excellent and appropriate.

Infection control has also been taken fully into account, with almost all instruments now being fully autoclavable.

The FUJINON manufacturing environment has achieved both ISO9001 certification, the standard for quality control awarded by the International Organization for Standardization, and EN46001 certification, the European standard for quality control of medical devices. For doctors aiming to offer high-quality, safe treatment, FUJINON instruments are sure to prove a reliable assistant.

Product Key

The FT Series Endoscopy Instruments use a system of abbreviations to indicate its function, design and dimensions. The Product Key below is designed to help in choosing the appropriate instrument for every need.

BF	24	16	SF
A	B	C	D

- A Product Model Name (Biopsy Forceps)
- B External Diameter of Jaw (2.4mm)
- C Length of Instrument (160cm)
- D Type of Instrument (Standard Fenestrated)

page

4	BF	Biopsy Forceps	SF	Standard Fenestrated	
			FN	Standard Fenestrated with Needle	
			LN	Long-diameter Fenestrated with Needle	
6	GF	Grasping Forceps	T	Three Prong	
			B	Basket	
			A	Alligator Jaw	
			WA	W-shaped Alligator Jaw	
			V	V-shaped	
			TT	Teflon Tube, Tapered Tip	
8	IN	Injector	MM	Metal Tube, Metal Tip	
			ST	Standard	
9	WT	Washing Tube	SP	Spray	
			N	Needle-shaped	
10	DK	Diathermic Knife	S	Papillotomy Knife Standard	
			T••G	Papillotomy Knife Tapered (guide-wire compatible)	
			T	Papillotomy knife Tapered	
			M	Half-moon	Standard
11	DS	Diathermic Snare	RM	Hexagonal	Rotatable
			H		Standard
			RH	Elliptical	Rotatable
			E		Standard
			RE	Standard	Rotatable
			S		Standard
15	CT	Cannulation Tube	C	Cone	
			L	Long Tapered	
			R	Round	
16	DC	Diathermic Coagulator	S	Spray	
			HB	Standard	
17	DP	Diathermic Probe	HB2	Long-diameter	
			—	Channel Washing Brush	
18	WB	Washing Brush	—	Air/Water Channel Washing Brush	
			—	Button Cylinder Washing Brush	
			—		

C O N T E N T S

Biopsy Forceps.....	4	Diathermic Coagulator.....	16
Grasping Forceps.....	6	Diathermic Probe.....	17
Injector.....	8	Washing Brush.....	18
Washing Tube.....	9	Accessories/Supplies.....	19
Diathermic Knife.....	10	Care and Cleaning.....	20
Diathermic Snare.....	11	Scope chart.....	22
Cannulation Tube.....	15		

Biopsy Forceps

BF

Tip cups are now harder-wearing than those of ordinary forceps, for a sharp cutting edge that lasts longer.



SF Standard Fenestrated

The hole incorporated in the center of each cup enables the sampling of more tissue while minimizing tissue damage.

Endoscope	Code	Channel	Effective length	Remarks	Autoclavable
Upper Gastrointestinal Endoscopes (EGD)	BF1818SF	2.0mm~	1800mm	—	○
	BF2416SF	2.8mm~	1600mm	—	○
	BF2418SF	2.8mm~	1800mm	—	○
Duodenoscopes (ERCP)	BF2418SF	2.8mm~	1800mm	—	○
Colonoscopes	BF2412SF	2.8mm~	1200mm	—	○
	BF2418SF	2.8mm~	1800mm	—	○
	BF2424SF	2.8mm~	2400mm	—	○
Enteroscopes (Small Bowel)	BF2430SF	2.8mm~	3000mm	—	○
Double Balloon Endoscopes	BF1824SF	2.0mm~	2400mm	—	○
Bronchoscopes	BF1812SF	2.0mm~	1200mm	—	○
	BF2412SF	2.8mm~	1200mm	—	○



LN Long-diameter Fenestrated with Needle

Oval-shaped cups enable the sampling of substantial amounts of deep-level tissue, and the needle allows for better retention of sample in general.

Endoscope	Code	Channel	Effective length	Remarks	Autoclavable
Upper Gastrointestinal Endoscopes (EGD)	BF2416LN	2.8mm~	1600mm	—	○
	BF2418LN	2.8mm~	1800mm	—	○
Duodenoscopes (ERCP)	BF2418LN	2.8mm~	1800mm	—	○
Colonoscopes	BF2412LN	2.8mm~	1200mm	—	○
	BF2418LN	2.8mm~	1800mm	—	○
	BF2424LN	2.8mm~	2400mm	—	○
Bronchoscopes	BF2412LN	2.8mm~	1200mm	—	○



FN Standard Fenestrated with Needle

The needle allows for multiple tissue samples and better retention of samples in general.

Endoscope	Code	Channel	Effective length	Remarks	Autoclavable
Upper Gastrointestinal Endoscopes (EGD)	BF1818FN	2.0mm~	1800mm	—	○
	BF2416FN	2.8mm~	1600mm	—	○
	BF2418FN	2.8mm~	1800mm	—	○
Duodenoscopes (ERCP)	BF3018FN	3.7mm~	1800mm	—	○
Colonoscopes	BF2418FN	2.8mm~	1800mm	—	○
	BF2412FN	2.8mm~	1200mm	—	○
	BF2418FN	2.8mm~	1800mm	—	○
Enteroscopes (Small Bowel)	BF2424FN	2.8mm~	2400mm	—	○
Double Balloon Endoscopes	BF3024FN	3.7mm~	2400mm	—	○
Bronchoscopes	BF1812FN	2.0mm~	1200mm	—	○
	BF2412FN	2.8mm~	1200mm	—	○

Grasping Forceps

GF

Designed for safe, reliable retrieval of foreign bodies.



T Three Prong

Three prong provides a gentle grasp that does not damage the tissue being collected, enabling sampling to proceed smoothly.

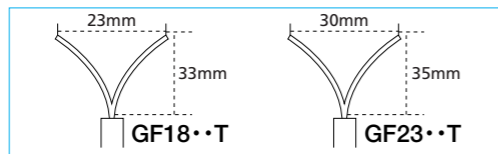

Endoscope	Code	Channel	Total length	Remarks	Autoclavable
Upper Gastrointestinal Endoscopes (EGD)	GF1818T	2.0mm~	1800mm	Handle HA50 sold separately	○
	GF2316T	2.8mm~	1600mm		○
	GF2318T	2.8mm~	1800mm		○
Duodenoscopes (ERCP)	GF2318T	2.8mm~	1800mm		○
	GF2312T	2.8mm~	1200mm		○
Colonoscopes	GF2318T	2.8mm~	1800mm		○
	GF2323T	2.8mm~	2300mm		○
	GF2325T	2.8mm~	2500mm	○	
Enteroscopes (Small Bowel)	GF1824T	2.0mm~	2400mm	○	
Bronchoscopes	GF1812T	2.0mm~	1200mm	○	



B Basket

The basket maintains an appropriate level of tension and flexibility, ideal for retrieval of slippery foreign bodies.

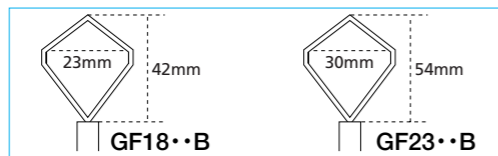

Endoscope	Code	Channel	Total length	Remarks	handle	Autoclavable
					HA50 HA100	
Upper Gastrointestinal Endoscopes (EGD)	GF1818B	2.0mm~	1800mm	Handle HA100 sold separately		○
	GF2318B	2.8mm~	1800mm			○
Duodenoscopes (ERCP)	GF2318B	2.8mm~	1800mm			○
	GF2312B	2.8mm~	1200mm			○
Colonoscopes	GF2318B	2.8mm~	1800mm			○
	GF2323B	2.8mm~	2300mm			○
	GF2325B	2.8mm~	2500mm			○
Bronchoscopes	GF1812B	2.0mm~	1200mm	○		
	GF2312B	2.8mm~	1200mm	○		



A Alligator Jaw

The hooked tip ensures a firm grip, enabling swift retrieval of even complex foreign bodies.

Endoscope	Code	Channel	Effective length	Remarks	Autoclavable
Upper Gastrointestinal Endoscopes (EGD)	GF2418A	2.8mm~	1800mm	—	○
Duodenoscopes (ERCP)	GF2418A	2.8mm~	1800mm	—	○
	GF2418A	2.8mm~	1800mm	—	○
Colonoscopes	GF2418A	2.8mm~	1800mm	—	○
	GF2424A	2.8mm~	2400mm	—	○



WA W-shaped Alligator Jaw

W-shaped grooves in the tip of these alligator forceps enables the retrieval of larger samples of tissue during mucosal resection.

Endoscope	Code	Channel	Effective length	Remarks	Autoclavable
Colonoscopes	GF2323WA	2.8mm~	2300mm	—	○

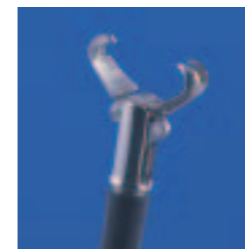

V V-shaped

Sharp v-shaped grooves in the tip permit the secure retrieval of foreign bodies that prove more difficult to grasp (i.e. coins, buttons, batteries.)

Endoscope	Code	Channel	Effective length	Remarks	Autoclavable
Upper Gastrointestinal Endoscopes (EGD)	GF1818V	2.0mm~	1800mm	—	○
	GF2416V	2.8mm~	1600mm	—	○
	GF2418V	2.8mm~	1800mm	—	○
Duodenoscopes (ERCP)	GF2418V	2.8mm~	1800mm	—	○
	GF2412V	2.8mm~	1200mm	—	○
Colonoscopes	GF2416V	2.8mm~	1600mm	—	○
	GF2418V	2.8mm~	1800mm	—	○
	GF2424V	2.9mm~	2400mm	—	○
	GF1812V	2.0mm~	1200mm	—	○
Bronchoscopes	GF1812V	2.0mm~	1200mm	—	○
	GF2412V	2.8mm~	1200mm	—	○

Injector IN

In addition to the materials used for needle tips and tubing, a range of needle diameters and lengths allows you to choose the ideal combination for each procedure.

These instruments are not pre-packaged sterile and require autoclave or gas sterilization prior to initial use.

Washing Tube WT

Washing tubes use running water to clean away debris or mucus from the site of a lesion and its surroundings, clearing the field of vision. This range includes two types of spray tube for use with dye sprays to highlight the shape and extent of lesions.

TT Teflon Tube, Tapered Tip



Teflon tubing makes it possible to check blood inflow during puncture, making procedures even safer.

Code
IN...TT 14
A B
A Range of needle diameters 1 : 21G 3 : 23G
B lengths allows 4 : 4mm 6 : 6mm

Endoscope	Code	Channel	Total length	Remarks	Autoclavable
Upper Gastrointestinal Endoscopes (EGD)	IN2318TT14	2.8mm~	1800mm	Unsterilized, needle:21G4mm	○
	IN2318TT16	2.8mm~	1800mm	Unsterilized, needle:21G6mm	○
	IN1818TT34	2.0mm~	1800mm	Unsterilized, needle:23G4mm	○
	IN1818TT36	2.0mm~	1800mm	Unsterilized, needle:23G6mm	○
Duodenoscopes (ERCP)	IN2318TT14	2.8mm~	1800mm	Unsterilized, needle:21G4mm	○
	IN2318TT16	2.8mm~	1800mm	Unsterilized, needle:21G6mm	○
Colonoscopes	IN2318TT14	2.8mm~	1800mm	Unsterilized, needle:21G4mm	○
	IN2318TT16	2.8mm~	1800mm	Unsterilized, needle:21G6mm	○
	IN2323TT14	2.8mm~	2300mm	Unsterilized, needle:21G4mm	○
	IN2323TT16	2.8mm~	2300mm	Unsterilized, needle:21G6mm	○
Bronchoscopes	IN1812TT34	2.0mm~	1200mm	Unsterilized, needle:23G4mm	○
	IN1812TT36	2.0mm~	1200mm	Unsterilized, needle:23G6mm	○

ST Standard



This tube uses running water to clean debris and mucus from lesion sites, making observation easy. Ideal for routine use, it comes in different effective lengths for use with the corresponding scopes.

Endoscope	Code	Channel	Effective length	Remarks	Autoclavable
Upper Gastrointestinal Endoscopes (EGD)	WT1720ST	2.0mm~	2000mm	—	×
Duodenoscopes (ERCP)	WT1720ST	2.0mm~	2000mm	—	×
Colonoscopes	WT1720ST	2.0mm~	2000mm	—	×
	WT1726ST	2.0mm~	2600mm	—	×
Bronchoscopes	WT1720ST	2.0mm~	2000mm	—	×

MM Metal Tube, Metal Tip



A highly maneuverable metal tip is attached to the insertion section.

Code
IN...MM 14
A B
A Range of needle diameters 1 : 21G 3 : 23G
B lengths allows 4 : 4mm 6 : 6mm

Endoscope	Code	Channel	Total length	Remarks	Autoclavable
Upper Gastrointestinal Endoscopes (EGD)	IN2318MM14	2.8mm~	1800mm	Unsterilized, needle:21G4mm	○
	IN1818MM34	2.0mm~	1800mm	Unsterilized, needle:23G4mm	○
	IN1818MM36	2.0mm~	1800mm	Unsterilized, needle:23G6mm	○
Duodenoscopes (ERCP)	IN2318MM14	2.8mm~	1800mm	Unsterilized, needle:21G4mm	○
Colonoscopes	IN2318MM14	2.8mm~	1800mm	Unsterilized, needle:21G4mm	○
	IN2323MM14	2.8mm~	2300mm	Unsterilized, needle:21G4mm	○
Double Balloon Endoscopes	IN1824TT34N6	2.0mm~	2400mm	Contains 1 sheath and 6 needles	○
	IN2323TT16	2.8mm~	2300mm	Teflon tube / Tapered tip	○
Bronchoscopes	IN1812MM34	2.0mm~	1200mm	Unsterilized, needle:23G4mm	○
	IN1812MM36	2.0mm~	1200mm	Unsterilized, needle:23G6mm	○

SP Spray



These tubes are particularly suitable for spraying dyes. Chemical solutions can be sprayed from the tip over a wide area.

Endoscope	Code	Channel	Effective length	Remarks	Autoclavable
Upper Gastrointestinal Endoscopes (EGD)	WT2417WS	2.8mm~	1700mm	—	○
	WT2423WS	2.8mm~	2300mm	—	○
Duodenoscopes (ERCP)	WT2423WS	2.8mm~	2300mm	—	○
Colonoscopes	WT2423WS	2.8mm~	2300mm	—	○

Diathermic Knife

DK

The lineup includes a wide variety of tip types and needle lengths, to make the complex approach to the opening of the papilla easy and enable swift, sure papillary sphincterotomy.



N Needle-shaped

The tip of this high-frequency knife is needle-shaped, making it effective for precutting in cases where constriction of the papilla makes it difficult to insert a papillotomy knife. Choose from four different needle lengths: 4 mm, 5 mm, 6 mm, and 8 mm.

Endoscope	Code	Channel	Total length	Remarks	Autoclavable	
Duodenoscopes (ERCP)	DK1821N4	2.0mm~	2100mm	needle lengths 4mm	Handle HA50D Connection cord sold separately	<input type="radio"/>
	DK1821N5	2.0mm~	2100mm	needle lengths 5mm		<input type="radio"/>
	DK1821N6	2.0mm~	2100mm	needle lengths 6mm		<input type="radio"/>
	DK1821N8	2.0mm~	2100mm	needle lengths 8mm		<input type="radio"/>



S Papillotomy Knife – Standard

This pull-type knife uses a cutting wire pulled into a bow shape to make the incision. Choose from four different cutting lengths: 20 mm, 25 mm, 30 mm, and 40 mm.

Endoscope	Code	Channel	Total length	Remarks	Autoclavable	
Duodenoscopes (ERCP)	DK1821S20	2.0mm~	2100mm	cutting lengths 20mm	Handle HA50D Connection cord sold separately	<input type="radio"/>
	DK1821S25	2.0mm~	2100mm	cutting lengths 25mm		<input type="radio"/>
	DK1821S30	2.0mm~	2100mm	cutting lengths 30mm		<input type="radio"/>
	DK1821S40	2.0mm~	2100mm	cutting lengths 40mm		<input type="radio"/>

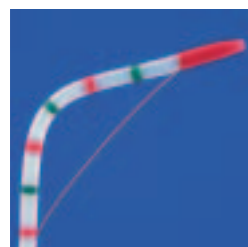

T Papillotomy Knife – Tapered

The tapered tip makes this an appropriate papillotomy knife for cases of papillary constriction or diverticulitis.

Endoscope	Code	Channel	Total length	Remarks	Autoclavable	
Duodenoscopes (ERCP)	DK1821T20	2.0mm~	2100mm	cutting lengths 20mm	Handle HA50D Connection cord sold separately	<input type="radio"/>
	DK1821T25	2.0mm~	2100mm	cutting lengths 25mm		<input type="radio"/>
	DK1821T30	2.0mm~	2100mm	cutting lengths 30mm		<input type="radio"/>
	DK1821T40	2.0mm~	2100mm	cutting lengths 40mm		<input type="radio"/>
	DK2221T30G*	2.8mm~	2100mm	cutting lengths 30mm		<input type="radio"/>

* (guide-wire compatible)

Diathermic Snare

DS

This lineup includes standard, rotating, and insulated rotating types of snares. The rotating type, in particular, possesses outstanding maneuverability, minimizing stress on the operator.



M Half-moon Standard

The loop of this half-moon-shaped snare can be adjusted to the appropriate width for different sizes of polyps.

Endoscope	Code	Channel	Total length	Remarks	Autoclavable
Upper Gastrointestinal Endoscopes (EGD)	DS1816M	2.0mm~	1600mm	Handle HA100D Connection cord sold separately	<input type="radio"/>
	DS2316M	2.8mm~	1600mm		<input type="radio"/>
	DS2323M	2.8mm~	2300mm		<input type="radio"/>
Duodenoscopes (ERCP)	DS2312M	2.8mm~	1200mm		<input type="radio"/>
	DS2323M	2.8mm~	2300mm		<input type="radio"/>
	DS2325M	2.8mm~	2500mm		<input type="radio"/>



RM Half-moon Rotatable

The wire loop can be rotated, making it simple to excise polyps regardless of their location.

Endoscope	Code	Channel	Total length	Remarks	Autoclavable
Upper Gastrointestinal Endoscopes (EGD)	DS2316RM	2.8mm~	1600mm	Handle HA100D Connection cord sold separately	<input type="radio"/>
	DS2323RM	2.8mm~	2300mm		<input type="radio"/>
Duodenoscopes (ERCP)	DS2323RM	2.8mm~	2300mm		<input type="radio"/>
	DS2325RM	2.8mm~	2500mm		<input type="radio"/>

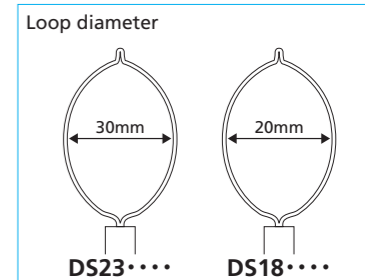



H Hexagonal – Standard

The hexagonal loop opens evenly on both sides, enabling the diameter of the loop to be adjusted exactly as envisioned by the operator.

Endoscope	Code	Channel	Total length	Remarks	Autoclavable
Upper Gastrointestinal Endoscopes (EGD)	DS1816H	2.0mm~	1600mm	Handle HA100D Connection cord sold separately	<input type="checkbox"/>
	DS2316H	2.8mm~	1600mm		<input type="checkbox"/>
	DS2323H	2.8mm~	2300mm		<input type="checkbox"/>
Double Balloon Endoscopes	DS1824H	2.0mm~	2400mm		<input type="checkbox"/>
Colonoscopes	DS2323H	2.8mm~	2300mm		<input type="checkbox"/>
	DS2325H	2.8mm~	2500mm		<input type="checkbox"/>
	DS2312H	2.8mm~	1200mm	<input type="checkbox"/>	



RH Hexagonal – Rotatable

The wire loop can be rotated, making it simple to excise polyps whatever their location.

Endoscope	Code	Channel	Total length	Remarks	Autoclavable
Upper Gastrointestinal Endoscopes (EGD)	DS2316RH	2.8mm~	1600mm	Handle HA100D Connection cord sold separately	<input type="checkbox"/>
	DS2323RH	2.8mm~	2300mm		<input type="checkbox"/>
Duodenoscopes (ERCP)	DS2323RH	2.8mm~	2300mm		<input type="checkbox"/>
	DS2325RH	2.8mm~	2500mm		<input type="checkbox"/>



E Elliptical – Standard

For excizing any size of polyp.

Endoscope	Code	Channel	Total length	Remarks	Autoclavable
Upper Gastrointestinal Endoscopes (EGD)	DS1816E	2.0mm~	1600mm	Handle HA100D Connection cord sold separately	<input type="checkbox"/>
	DS2316E	2.8mm~	1600mm		<input type="checkbox"/>
	DS2323E	2.8mm~	2300mm		<input type="checkbox"/>
Duodenoscopes (ERCP)	DS2323E	2.8mm~	2300mm		<input type="checkbox"/>
	DS2325E	2.8mm~	2500mm		<input type="checkbox"/>



RE Elliptical – Rotatable

The wire loop can be rotated, making it simple to excise polyps whatever their location.

Endoscope	Code	Channel	Total length	Remarks	Autoclavable
Upper Gastrointestinal Endoscopes (EGD)	DS2316RE	2.8mm~	1600mm	Handle HA100D Connection cord sold separately	<input type="checkbox"/>
	DS2323RE	2.8mm~	2300mm		<input type="checkbox"/>
Duodenoscopes (ERCP)	DS2323RE	2.8mm~	2300mm		<input type="checkbox"/>
	DS2325RE	2.8mm~	2500mm		<input type="checkbox"/>

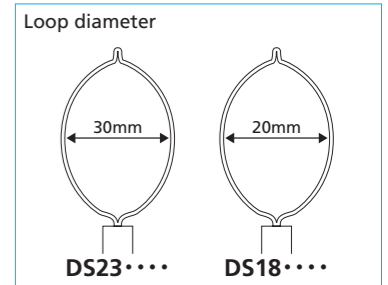

Cannulation Tube

CT

A 1,200-mm mandolin wire prevents the tube from folding during insertion into the forceps aperture, and make it easier to insert and more maneuverable than other similar products. Procedures can be carried out swiftly and surely even for a constricted papilla or where the papillary opening is small. Choose the appropriate tube for the patient's condition or the technique to be used.

Attaching the HA50D

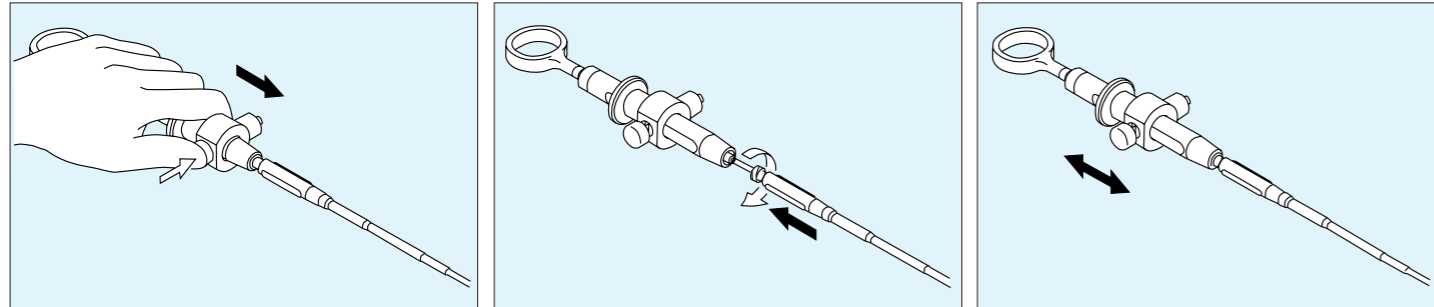

1. Move the handle of the slider toward the insertion section. Continue pressing the button on the slider while inserting the wire coupling. Release the button once the coupling is fully inserted.
2. Screw the handle onto the luer locking section of the accessory.
3. Move the slider backwards and forwards to check that the insertion section is firmly fixed to the handle.



Handle HA50D (autoclavable)

Attaching the HA100D

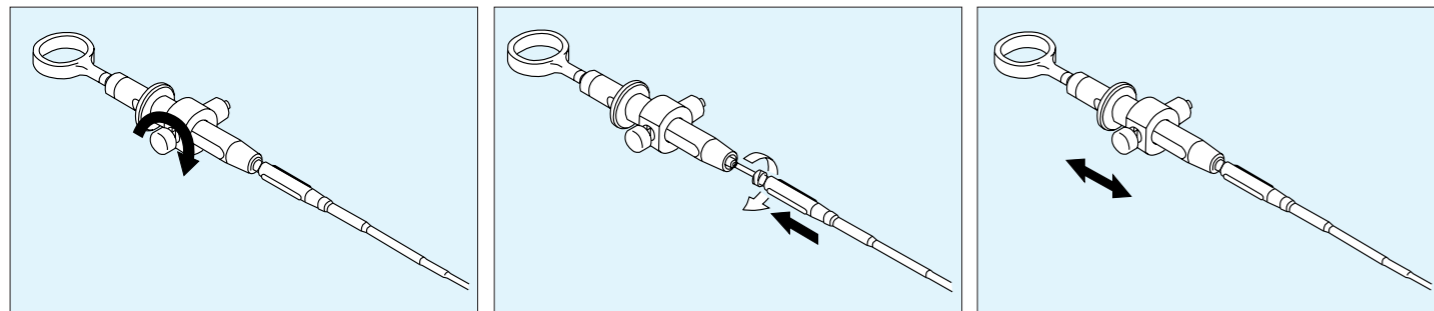

1. Move the handle of the slider toward the insertion section. Insert the wire coupling. Tighten the slider fixing screw, once the coupling is fully inserted.
2. Screw the handle onto the luer locking section of the accessory.
3. Move the slider backwards and forwards to check that the insertion section is firmly fixed to the handle.



Handle HA100D (autoclavable)

Handle	HA50D
	HA100D
Connection cord	ACD-VL



S Standard

An extremely versatile tube for routine use that enables the smooth injection even of highly viscous contrast media.

Endoscope	Code	Channel	Total length	Remarks	Autoclavable
Duodenoscopes (ERCP)	CT1821S	2.0mm~	2100mm	—	○



C Cone

The conical tip of this tube makes it effective for the approach to a constricted or accessory papilla. It is also effective for use in pediatric patients.

Endoscope	Code	Channel	Total length	Remarks	Autoclavable
Duodenoscopes (ERCP)	CT1821C	2.0mm~	2100mm	—	○



L Long Tapered

This tube has a long, narrow tip that is effective for the approach to the accessory papilla.

Endoscope	Code	Channel	Total length	Remarks	Autoclavable
Duodenoscopes (ERCP)	CT1821L	2.0mm~	2100mm	—	○

Diathermic Coagulator

DC

Hemostatic procedures must often be carried out in emergency situations, and the cause and location of bleeding is different in each case.

These hemostatic instruments are designed with a variety of different tip shapes for effective hemostasis in a wide range of situations.

R Round



An effective tool using high-frequency waves for coagulation and hemostasis of bleeding from small blood vessels.

Endoscope	Code	Channel	Total length	Remarks	Autoclavable
Upper Gastrointestinal Endoscopes (EGD)	DC1818R	2.0mm~	1800mm		○
	DC2316R	2.8mm~	1600mm		○
	DC2318R	2.8mm~	1800mm		○
Duodenoscopes (ERCP)	DC2318R	2.8mm~	1800mm	Connection cord sold separately	○
Double Balloon Endoscopes	DC1824R	2.0mm~	2400mm		○
Colonoscopes	DC2318R	2.8mm~	1800mm		○
	DC2323R	2.8mm~	2300mm		○
	DC2325R	2.8mm~	2500mm		○

S Spray



Because this coagulator is inserted via [OK?] the washing channel, hemostatic procedures can be carried out while observing the site of bleeding.

Endoscope	Code	Channel	Total length	Remarks	Autoclavable
Upper Gastrointestinal Endoscopes (EGD)	DC2316S	2.8mm~	1600mm		○
	DC2318S	2.8mm~	1800mm		○
Duodenoscopes (ERCP)	DC2318S	2.8mm~	1800mm	Connection cord sold separately	○
Colonoscopes	DC2318S	2.8mm~	1800mm		○
	DC2323S	2.8mm~	2300mm		○
	DC2325S	2.8mm~	2500mm	○	
Bronchoscopes	DC2312S	2.8mm~	1200mm		○

Connection cord ACD-VL

Diathermic Probe

DP

Tissue excision and hemostasis can be carried out simultaneously, making these probes effective for small-scale mucosal resections such as sessile polyps and small polyps.

HB Standard



Endoscope	Code	Channel	Total length	Remarks	Autoclavable
Upper Gastrointestinal Endoscopes (EGD)	DP2316HB	2.8mm~	1600mm		○
	DP2318HB	2.8mm~	1800mm		○
Duodenoscopes (ERCP)	DP2318HB	2.8mm~	1800mm	Handle HA50D Connection cord sold separately	○
Double Balloon Endoscopes	DP1824HB	2.0mm~	2400mm		○
Colonoscopes	DP2312HB	2.8mm~	1200mm		○
	DP2318HB	2.8mm~	1800mm	○	
	DP2323HB	2.8mm~	2300mm	○	
	DP2325HB	2.8mm~	2500mm	○	

HB2 Long-diameter



Endoscope	Code	Channel	Total length	Remarks	Autoclavable
Upper Gastrointestinal Endoscopes (EGD)	DP2323HB2	2.8mm~	2300mm		○
	DP2523HB2	2.8mm~	2300mm		○
Duodenoscopes (ERCP)	DP2323HB2	2.8mm~	2300mm	Handle HA50D Connection cord sold separately	○
	DP2523HB2	2.8mm~	2300mm		○
Colonoscopes	DP2323HB2	2.8mm~	2300mm		○
	DP2525HB2	2.8mm~	2500mm	○	

handle HA50D
Connection cord ACD-VL



Handle HA50D (autoclavable)

Washing Brush

WB

Brushes for cleaning off any debris adhering to the inside of the channel. Choose the ideal brush for the channel diameter and effective length of your own particular scope.



FW2 Channel Washing Brush

Brushes to clean off debris adhering to the inside of the suction channel.

Endoscope	Code	Channel	Effective length	Remarks	Autoclavable
Upper Gastrointestinal Endoscopes (EGD)	WB3218FW2	2.0~2.8mm	1800mm	—	×
	WB4321FW2	3.8mm~	2100mm	—	×
Duodenoscopes (ERCP)	WB3521FW2	2.8~3.2mm	2100mm	—	×
	WB4321FW2	3.8mm~	2100mm	—	×
Colonoscopes	WB3521FW2	2.8~3.2mm	2100mm	—	×
Enteroscopes (Small Bowel)	WB3530FW	2.8~3.2mm	3000mm	—	×
Double Balloon Endoscope	WB3224FW2	2.0~2.8mm	2400mm	—	×
Bronchoscopes	WB3212FW2	2.0~2.8mm	1200mm	—	×



FW2 Air/Water Channel Washing Brush

A brush to clean the air and water channels of scopes in the 8 Series, including the ED-450XT8, ED-450XL8, ED-250XT8, and ED-250XL8.

Endoscope	Code	Channel	Effective length	Remarks	Autoclavable
AW channel washing brush	WB2221FW2	—	—	For the 8 Series	×



FW2 Button Cylinder Washing Brush

A brush to clean the suction, air, and water cylinder sections and their buttons.

Endoscope	Code	Channel	Effective length	Remarks	Autoclavable
Cylinder washing brush	WB11001FW2	—	—	Set of 3 pieces	×

Accessories and Supplies

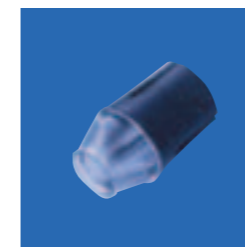

EMR ST Hood

Placing this hood over mucosal resection incisions makes submucosal resection simple. It enables reliable resection not only of horizontal but also vertical margins. The inside of the incision can be observed through the scope, making safe incision possible. The high-frequency knife can also be precisely controlled.

Description	Code	Outer diameter	Tip aperture diameter	Flexible section diameter of corresponding endoscopes	Autoclavable
EMR ST Hood	DH-15GR	Φ 12.2mm	Φ 7mm	9.4mm~10.0mm	×



EMR ST Hood

Placing this hood over mucosal resection incisions makes submucosal resection simple. It enables reliable resection not only of horizontal but also vertical margins. The inside of the incision can be observed through the scope, making safe incision possible. The high-frequency knife can also be precisely controlled.

Description	Code	Outer diameter	Tip aperture diameter	Flexible section diameter of corresponding endoscopes	Autoclavable
EMR ST Hood	DH-16CR	Φ 16mm	Φ 7mm	12.8mm~13.5mm	×

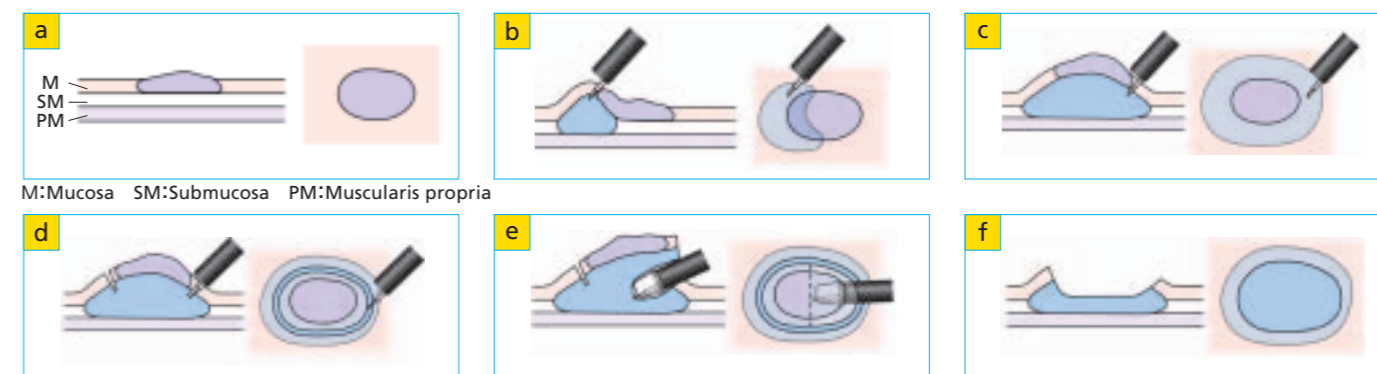

Care and Cleaning

Cleaning

Warning If some time elapses between when instruments are used and when they are washed it may not be possible to clean them adequately, and proper disinfection and sterilization may become impossible. Always clean instruments immediately after use.

Note Bending or folding may cause damage to the tip. Do not use excessive force.
* If jaws or prongs will not move because they are encased in debris, forcibly moving the slider may damage the equipment. In this case, soak the jaws or prongs in warm water for a while, then move them gradually.

How to clean biopsy forceps

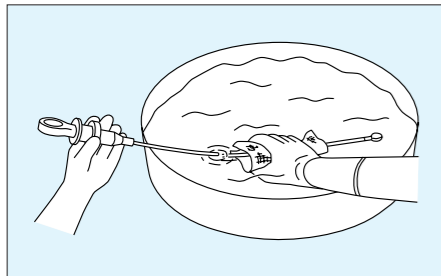

1. Wearing rubber gloves, use a sponge or brush to clean the biopsy forceps in a bowl filled with washing liquid.

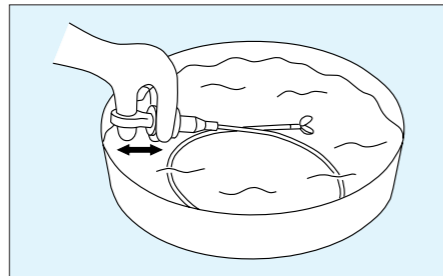

2. Operate the handle to open and close the jaws while the forceps are immersed, and use a washing sponge or brush to clean the biopsy forceps.

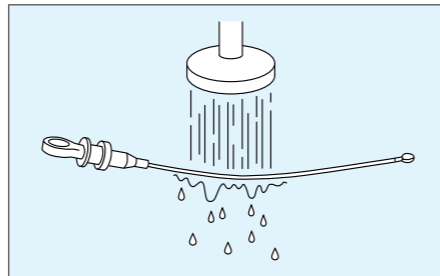

3. Remove the forceps from the washing liquid and rinse them under running water.
4. Dry off the water with a piece of gauze.

How to clean snares

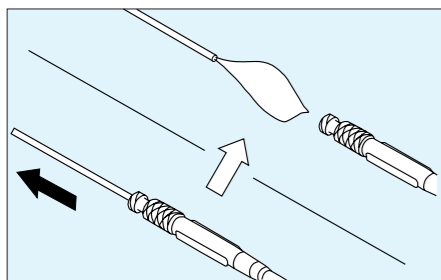

1. Take the high-frequency knife off the handle.
2. Pull the snare wire out of the tube.

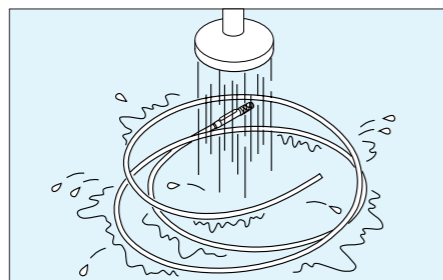

3. Wearing rubber gloves, use a sponge or rubber gloves to clean the snare and tube in a bowl filled with washing liquid.

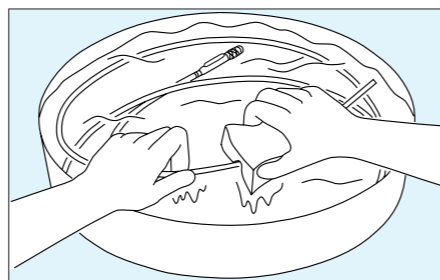

4. Remove them from the washing liquid and rinse under running water.
5. Dry off the water with a dry piece of gauze.

How to clean cannulation tubes

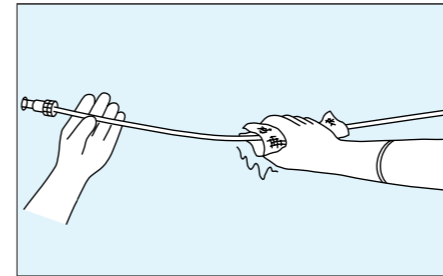

1. Wipe off the surface with a piece of gauze soaked in washing liquid.

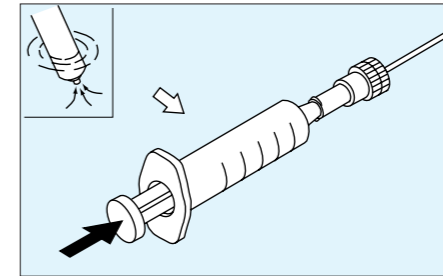

2. With the cannulation tube immersed in washing liquid, use a syringe to draw washing liquid up into the tube.

3. Clean the cannulation tube by using ultrasound.

4. Remove the cannulation tube from the washing liquid, and use a syringe to introduce washing liquid into the tube to flush it out.

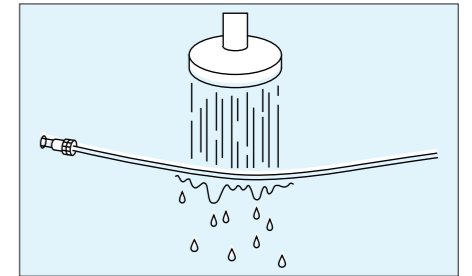

5. Remove the cannulation tube from the washing liquid and rinse under running water (purified water).

6. Dry off the water with a piece of sterile gauze.

7. Roll up the insertion section and seal it in a sterile pack.

Ultrasound Cleaning

Carry out ultrasound cleaning at a frequency of 40 kHz for five minutes. Follow the instructions that came with your ultrasound cleaning equipment.

Autoclaving

After placing the sealed sterilizing pack containing the forceps inside the autoclaving equipment, put them into a metal instrument box for use in the sterilizer, and autoclave for the times and at the temperatures given in the table on the right. (Placing the instruments directly into the autoclave may cause damage.) For the conditions for sterilization, follow the appropriate guidelines for cleaning, disinfection, and sterilization, or the recommendations given by the manufacturers of the sterilizer. Follow your own institution's guidelines for autoclave sterilization. When operating autoclave equipment, follow the instructions that came with the equipment or those supplied by the manufacturer.

Autoclaving time and temperature

	Temperature	Time
Forceps	134°C	3 minutes
Tubes	134°C	12 minutes
Snares	134°C	12 minutes

(N.B. In some autoclaves, the temperature while drying rises higher than the set temperature. In this case, turn the "Dry" switch off before use.)

Storage

Warning Packing biopsy forceps away in the carrying case and using it for storage may result in the inside of the case becoming a source of infection. Do not store biopsy forceps in the carrying case.

Note Do not store in a place that does not meet the storage conditions, as this may result in malfunction. Rolling up the insertion section into a diameter of less than 200 mm for storage may result in malfunction. Do not force the insertion section in order to store it.

Storage conditions

Store biopsy forceps following chemical disinfection or gas sterilization. Store biopsy forceps in a place that meets the following conditions.

- Temperature : 10~30°C
- Humidity : 30~85%
(however, not in a state of condensation)
- Air pressure : 70~106kpa (atmospheric pressure range)
- Location : Out of direct sunlight

Storage holes

Pass the jaws or nails at the tip up through this hole, and store so that the jaws or prongs do not touch the floor.

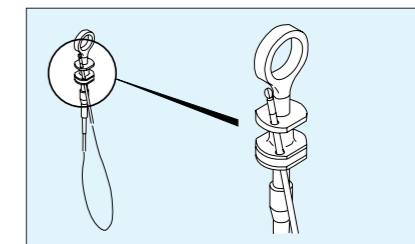

Scope Chart

Blue : 200 Series
Red : 400 Series

		Effective length of forceps channel									
		575mm	790mm	1020mm~1100mm	1235mm~1250mm	1270mm~1550mm	1600mm~1690mm	2300mm			
Diameter of scope forceps aperture	2.0mm	EB-250S	EB-410S EB-450S	EG-270N5 EG-270N	EG-470N EG-470N5						
	2.2mm			EG-250PE2 EG-250PE5	EG-450PE5 EG-410PE EG-450PE	EG-200PE EG-250PE		EN-450P5			
	2.8mm	EB-250T	EB-450T	EG-250HR2 EG-250WR5 EG-250FP5 EG-250FP EG-250D EG-201FP	EG-485ZH EG-450ZW5 EG-485HR EG-450WR5 EG-450G EG-450HR EG-410V EG-410HR EG-410FP2 EG-450D EG-410D EG-450D5 EG-410CR EG-490WR5 EG-490ZW5 EG-590WR EG-590ZW	ED-410XL ED-410MP	EG-250HR EG-200FP EG-200HR	EC-410MP type13 EC-410MP type15 EC-410D EC-450DM5	EC-200MP EC-450DL5	EN-200WM type23 EN-410WM type23 EN-450T5	
	3.2mm		ES-200ER	ES-410WE ES-450WE5		ED-250XL8 ED-250XL5 ED-250XL EC-200WM2	ED-450XL ED-450XL8 ED-450XL5 ED-420XL	EC-250MP5 EC-250WM	EC-410WM EC-485ZW EC-450ZH EC-410HM EC-410D type13,15 EC-410CM EC-410CW EC-450MP5	EC-250LP5 EC-250LP EC-200MR EC-200WM	EC-450LP EC-450LP5 EC-410HL
	3.7mm } 3.8mm				EG-250D EG-250CT5 EG-250D5	EG-450D EG-410D EG-450D5 EG-450CT5	ED-410XU	ED-200XU EC-250WM5 EC-201WM EC-201WI	EC-450WM5 EC-450WI5 EC-450ZW5/M EC-450DM5 EC-490ZW5 EC-590ZW/M	EC-250WL5 EC-250HL5 EC-201WL	EC-450WL5 EC-450ZW5/L EC-450DL5 EC-490ZW5/L EC-590ZW/L
	4.2mm				EG-200CT	EG-410CT	ED-250XT8 ED-250XT	ED-450XT8 ED-450XT5 ED-410XT ED-450XT			